

**FIRST AMENDMENT TO SPECIAL DISTRICT PUBLIC DISCLOSURE DOCUMENT  
COLORADO CROSSING METROPOLITAN DISTRICT NO. 2**

As required pursuant to Section 32-1-104.8 of the Colorado Revised Statutes (“**C.R.S.**”), Colorado Crossing Metropolitan District No. 2 (“**District**”) recorded its Public Disclosure Document on July 6, 2015 in the real property records of El Paso County at Reception Number 215071138 (“**Public Disclosure Document**”).

The District has changed its boundaries pursuant to Section 32-1-401, *et. seq.*, C.R.S. and/or Section 32-1-501, *et. seq.*, C.R.S.

Exhibit A to the Public Disclosure Document is hereby deleted in its entirety, and substituted in lieu thereof shall be **Exhibit A**, an updated boundary map of the District, attached hereto and incorporated herein.

Dated this 20th day of March, 2023.

**EXHIBIT A**

Updated District Map

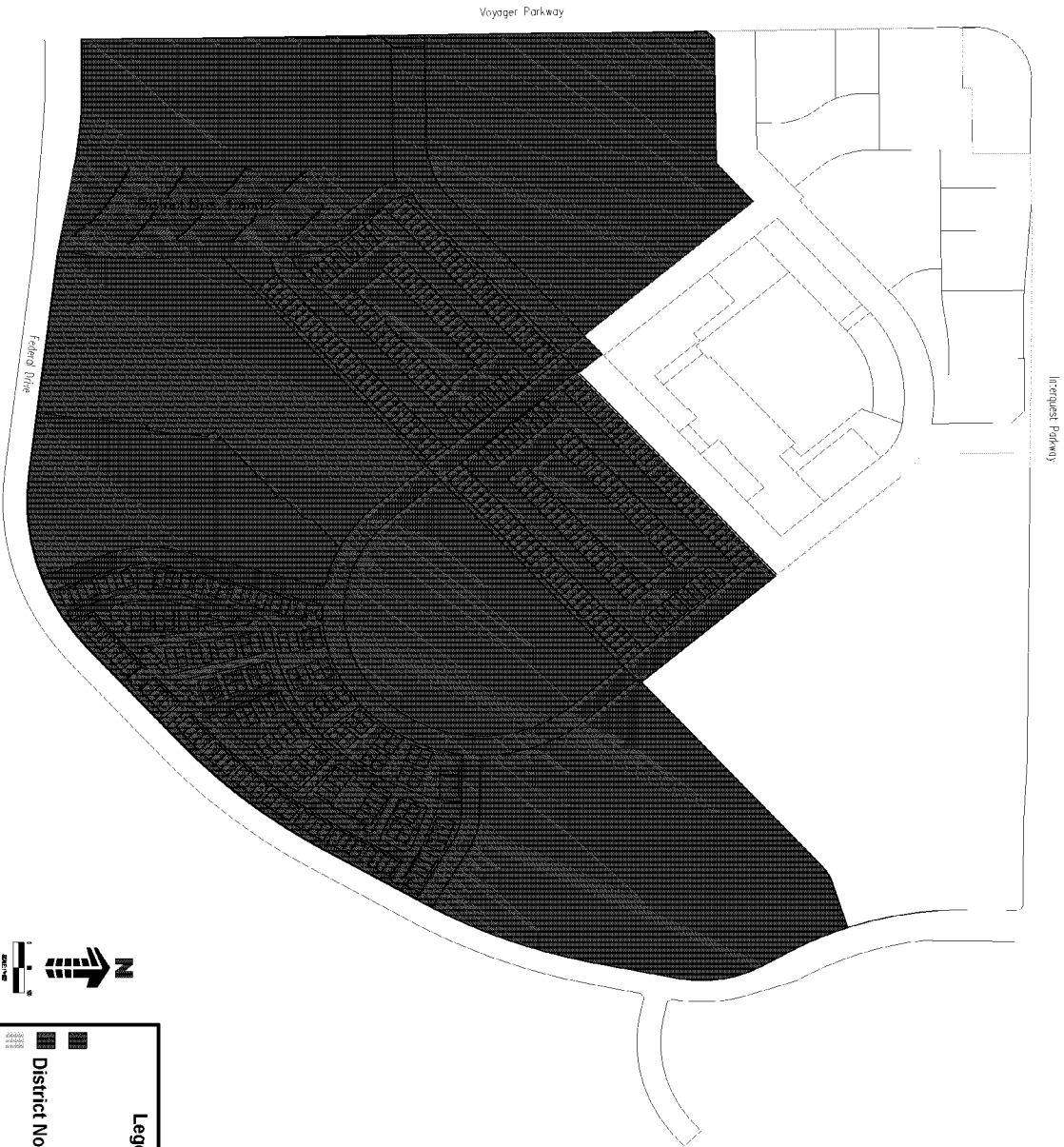

**Legend**

	District No. 2
	District Nos. 1 & 2

**Colorado Crossing Metro District Exhibit**  
 CITY OF COLORADO SPRINGS, COUNTY OF EL PASO, STATE OF COLORADO.

#	Date	Revised/Description	By