

**FIRST AMENDMENT TO SPECIAL DISTRICT PUBLIC DISCLOSURE DOCUMENT**  
**COLORADO CROSSING METROPOLITAN DISTRICT NO. 1**

As required pursuant to Section 32-1-104.8 of the Colorado Revised Statutes (“**C.R.S.**”), Colorado Crossing Metropolitan District No. 2 (“**District**”) recorded its Public Disclosure Document on December 26, 2014 in the real property records of El Paso County at Reception Number 214118969 (“**Public Disclosure Document**”).

The District has changed its boundaries pursuant to Section 32-1-401, *et. seq.*, C.R.S. and/or Section 32-1-501, *et. seq.*, C.R.S.

Exhibit A to the Public Disclosure Document is hereby deleted in its entirety, and substituted in lieu thereof shall be **Exhibit A**, an updated boundary map of the District, attached hereto and incorporated herein.

Dated this 20th day of March, 2023.

**EXHIBIT A**

Updated District Map

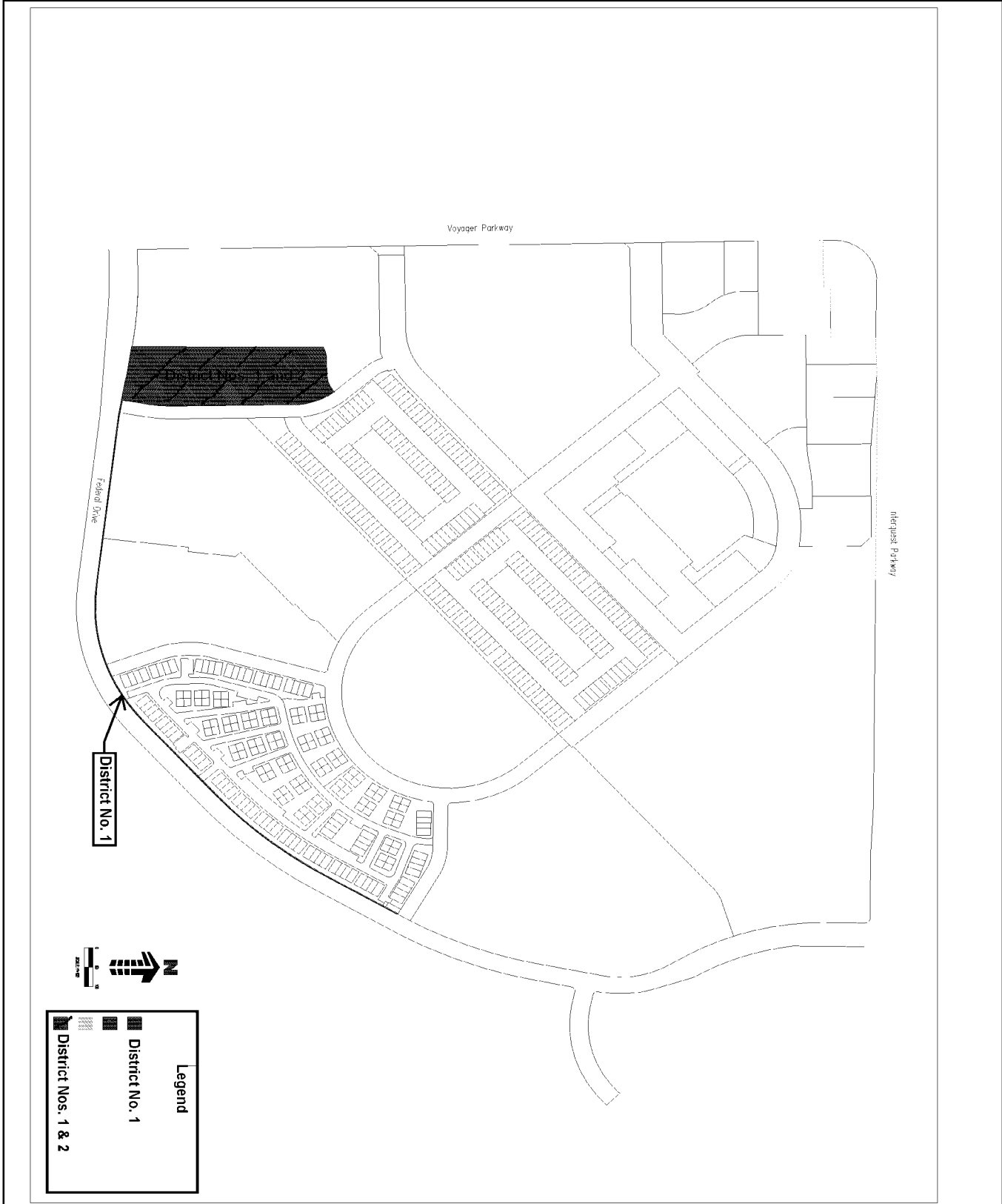

**Colorado Crossing Metro District No. 1**  
 CITY OF COLORADO SPRINGS, COUNTY OF EL PASO, STATE OF COLORADO.

**Galiloway**  
 Planning, Architecture, Engineering  
 6005 S. W. 10th Ave., Suite 200  
 Denver, CO 80202  
 Phone: 303.755.8888  
 Fax: 303.755.8889

#	Date	Issue/Description	By